



# *motif*

- Adjustable Suction Power
- LED Light Timer
- Backflow Prevention
- Stationary and Battery Powered

**ADJUST TO YOUR  
COMFORT LEVEL**



Please read user manual carefully before using this product

## Double Electric Breast Pump

## HOW TO USE



1. Wash hands thoroughly before handling. Wash and sterilize all the plastic parts before using. Make sure the breast pump has been assembled correctly. Get in a comfortable position and relax. Hold the pump in whichever hand is most comfortable. Place the breastshield on your breast and make sure your nipple is aligned with the center of the breastshield.

2. Turn on the breast pump by twisting the knob. Continue to revolve the knob to adjust the suction power. It can rotate up to 180° power.

3. Once the machine is on, the white light will keep on. From the beginning, all 10 blue lights on the side will be on. One blue light will turn off every 3 minutes until all turn off after 30 minutes the machine will go into "standby" mode. If you need to continue use, just twist the knob again and it the 30 minute timer will restart. Twist the knob to counter clockwise to turn off the pump.

4. You can adjust the suction power according to your own needs by twisting the knob.

**Note:** Please make sure the pump is working at room temperature and turn off the machine and disassemble the components after pumping session.

## PANEL ILLUSTRATION



10 Blue LED Light Timer



White Light Shows  
Suction Power



Twist to Turn Off



Maximum Suction Power



Minimum Suction Power

Suction pattern designed for maximum let down.

# COMPONENTS

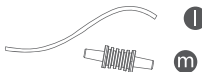
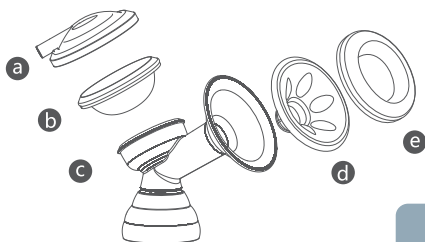

- a Diaphragm Top
- b Diaphragm
- c Connector
- d Massage Shield
- e Hygiene Cover
- f Silicone Gasket
- g Valve
- h Membrane
- i Storage Container
- j Container Base
- k Pump
- l Tubing
- m Tubing Connector
- n Power Adaptor
- o USB line

## ASSEMBLING THE PUMP

Wash hands thoroughly before using breast pump.



1. Snap the membrane onto the valve until the membrane lies completely flat.

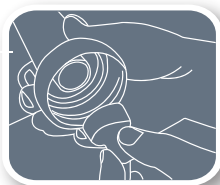
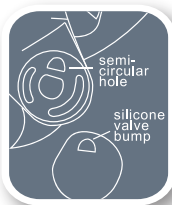

2. Push the valve up into the connector so that the seal is tight.

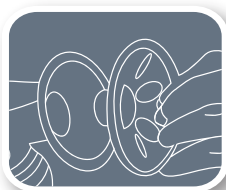

3. Attach the massage pad onto the breast-shield (optional).



4. Attach the diaphragm onto the top of the connector.

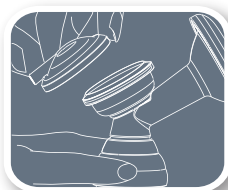

5. Attach the diaphragm top onto the bottom diaphragm piece.

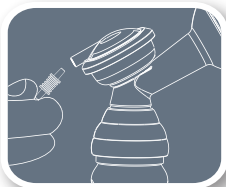

6. Insert the tubing connector and tubing into the diaphragm.



7. Screw the storage container onto the connector.

## ASSEMBLY CONTINUED

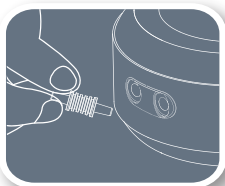

9. Insert the tubing connector into the hole on the breast pump

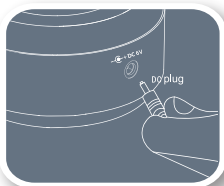

10. Insert the DC connector of USB cord into the DC port on the pump. Then insert the USB cord into the USB socket adaptor, insert the adaptor into power outlet.



11. When finished pumping, store milk in the refrigerator. Keep all electric parts dry. Wash components that come in contact with milk.

## Battery Installation

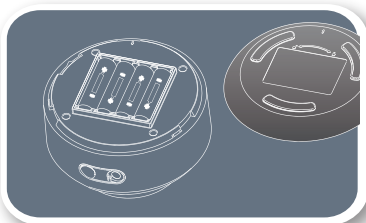

1. Open the battery cover, rotate the cover left and install 4 AA batteries, then close the battery cover.

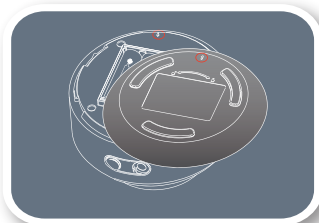

2. Align the battery cover arrow with the base arrow, then rotate to the right to lock.

**Note:**

1. Please make sure the pump works at room temperature. Turn off the machine and disassemble the components when not in use.
2. If you are only single pumping, follow the instructions below.

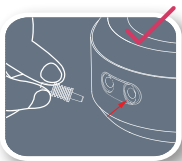

When single pumping, the tubing should plug into port on the right side.

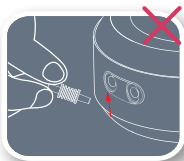

If single pumping, do NOT use the port with black button, there will be suction loss

**Symbols**



Class II



Type BF applied part



Stand by



Warning



Caution

**\*When pumping, keep an upright posture to prevent milk backflow.\***



Let air dry after cleaning and sterilizing.  
Do not sterilize the tubing (the tubing does not come in contact with breast milk).



cylinder



PVC tube

## IMPORTANT SAFEGUARDS

1. Read all instructions before use.
2. When using the adaptor, always use the correct voltage (100v-240v, DC 5V, 1A).
3. Only use the power adaptor that comes with the pump.
4. If the supply cord is damaged, replace immediately to avoid hazard.
5. Do not immerse motor unit in water or clean with wet sponge or cloth.
6. Keep all components out of reach of children as small parts can be a choking hazard.
7. Always unplug from wall charger when not using.
8. This appliance is not intended for the use by person (including children) with reduced physical, sensory or mental capabilities, or lack of experience and knowledge, unless they are under supervision or instruction concerning use of the appliance by a person responsible for their safety.
9. The working life for device and other accessories are 2 years.
10. Store in a cool and dry place. Heating from a fireplace or radiant heater or moisture can potentially cause problems.

## STORAGE CONDITIONS

Temperature: -4° to 104° Fahrenheit

Humidity: 10% - 70%

Atmospheric pressure: 850Hpa - 1060Hpa

## TROUBLESHOOTING

If there is low or no suction:

1. Make sure the breastshield seals properly around the breast.
2. Make sure all the parts have a tight seal .
3. Make sure the white valve membrane is laying flat against the white valve head. Make sure the valve and the membrane are not damaged.
4. Check the ends of the tubing are fit securely into the back of the breastshield and into the port of the breast pump.
5. Make sure the tubing is not plugged into the power jack.



## STORING BREASTMILK

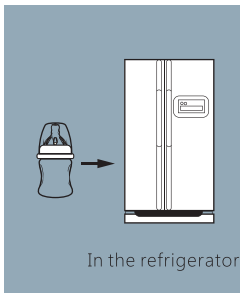

Ways to store breastmilk:

1. You can store breastmilk in the refrigerator for 48 hours at approximately 40°F.
2. When freezing milk, allow space at the top of the container for expansion.
3. Do not store breastmilk in the door of the refrigerator.

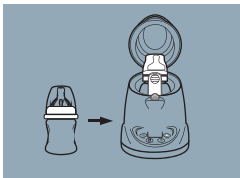

To warm milk:

1. In order to preserve breastmilk nutrition, thaw in refrigerator overnight or use bottle warmer set at 104°F.
2. Never defrost or heat milk in a microwave.

## STERILIZATION

Sterilizing:

1. After every use, hand wash all pieces that come in contact with milk.
2. Use a BPA-free sterilizer when using the microwave to clean.

Caution:

1. Do not sterilize or wash breast pump or power adaptor.
2. Allow parts to completely dry before next pumping session.

## E.M.C

1. This equipment has been tested and found to comply with the limits for medical devices in EN601-1-2. These limits are designed to provide reasonable protection against harmful interference in a typical medical installation.

2. This equipment generates, uses and can radiate radio frequency energy and, if not installed and used in accordance with the instructions, may cause harmful interference to other devices in the vicinity. However, there is no guarantee that interference will not occur in a particular installation.

3. If this equipment does cause harmful interference to other devices, which can be determined by turning the equipment off and on, the user is encouraged to try to correct the interference by one or more of the following measures :

- Reorient or relocate the receiving device.
- Increase the separation between the equipment.
- Connect the equipment into an outlet on a circuit different from that to which the other device(s) are connected.
- Consult the manufacturer or field service technician for help.

## EMC Guidelines

Below cables information are provided for EMC reference.

Cable	Max. cable length, Shielded/unshielded		Number	Cable classification
DC Power Line	5.9 ft	Nonshielded	1 Set	DC Power

Important information regarding Electro Magnetic Compatibility (EMC)

Double electric breast pump needs special precautions regarding EMC and put into service according to the EMC information provided in the user manual and other documents; Double electric breast pump conforms to this EN 60601-1-2:2007+AC:2010/IEC 60601-1-2:2007 standard for both immunity and emissions.

Nevertheless, special precautions need to be observed:

- The use of accessories and cable other than those specified, with the exception of accessories and cables sold by Motif Medical, LLC of the double electric breast pump as replacement parts for internal components, may result in increased EMISSIONS or decreased IMMUNITY or decreased LIFESPAN of the double electric breast pump.
- The double electric breast pump should not be used adjacent to or stacked with other equipment. In case adjacent or stacked use is necessary, the breast pump should be observed to verify normal operation in the configuration in which it will be used.

Recommended separation distances between portable and mobile RF communications equipment and the ME EQUIPMENT and ME SYSTEM – for ME EQUIPMENT and ME SYSTEM that are not LIFE-SUPPORTING.

Recommended separation distances between portable and mobile RF communications equipment and the MT-10.1-2			
The MT-10.1-2 is intended for use in an electromagnetic environment in which radiated RF disturbances are controlled. The customer or the user of the MT-10.1-2 can help prevent electromagnetic interference by maintaining a minimum distance between portable and mobile RF communications equipment (transmitters ) and the MT-10.1-2 as recommended below, according to the maximum output power of the communications equipment.			
Rated maximum output power of transmitter W	Separation distance according to frequency of transmitter		
	150kHz to 80 MHz $d = \left[ \frac{3.5}{P_t} \right] \sqrt{P}$	80MHz to 800MHz $d = \left[ \frac{3.5}{E_1} \right] \sqrt{P}$	800MHz to 2.5GHz $d = \left[ \frac{7}{E_1} \right] \sqrt{P}$
0.01	0.12	0.12	0.23
0.1	0.38	0.38	0.73
1	1.2	1.2	2.3
10	3.8	3.8	7.3
100	12	12	23

This specification shall include:

- \* intended medical indication;

The Double Electric Breast Pump is intended for the suction of lactating women and breast milk collection. This product does not have therapeutically effect. It is only for milk collection.

- intended PATIENT population;
  - a) Age: Reproductive age
  - b) Gender: Female in nursing period
  - c) Weight: not relevant
  - d) Health: lactating, others not specified
  - e) Nationality: multiple
  - f) PATIENT state:
- PATIENT can the OPERATOR

- intended part of the body or type of tissue applied to or interacted with;
- \* intended The device may contact with the skin of woman's breast. A work cycle is 30mins, so the contact time is limited which will not more than 24 hours.
- \* intended conditions of use; and patient can be the operator.

This appliance is not intended for use by persons (including children) with reduced physical, sensory or mental capabilities, or lack of experience and knowledge, unless they have been given supervision or instruction concerning use of the appliance by a person responsible for their safety. Children should be supervised to ensure that they do not play with the appliance. This appliance can be used above and persons with reduced physical, sensory or mental capabilities or lack of experience and knowledge if they have been given supervision or instruction concerning use of the appliance in a safe way and understand the hazards involved.

- \* operating principle (physical operating principles and significant physical and performance characteristics)

- Get the breast pump washed and sterilized before using
- Assemble the electric breast pump
- Connect the electrical connector, adaptor cord and power jack
- Place the cup over the breast
- Choose stimulation mode/ choose expression mode
- Display the suction mode
- Choose appropriate suction level
- Display suction level
- Extract breast milk
- Turn off the device/ automatically shutdown
- Store breast milk
- Warm milk
- Sterilization
- Detach the appliance
- Device protection

## EMC Information

### Guidance and manufacturer's declaration - electromagnetic emissions - for all ME EQUIPMENT and ME SYSTEM.

Table 1: Guidance and manufacturer's declaration – electromagnetic emissions		
The MT-10.1-2 is intended for use in the electromagnetic environment specified below. The customer or user of the MT-10.1-2 should assure that it is used in such an environment.		
Emissions test	Compliance	Electromagnetic environment - guidance
RF emissions CISPR 11	Group 1	The MT-10.1-2 uses RF energy only for its internal function. Therefore, its RF emissions are very low and are not likely to cause any interference in nearby electronic equipment
RF emissions CISPR 11	Class B	The MT-10.1-2 is suitable for use in all establishments, including domestic establishments and those directly connected to the public low-voltage power supply network that supplies buildings used for domestic purposes.
Harmonic emissions IEC 61000-3-2	Class A	
Voltage fluctuations/ Flicker emissions IEC 61000-3-3	Compliance	

### Guidance and manufacturer's declaration - electromagnetic immunity - for all ME EQUIPMENT and ME SYSTEM.

Table 2: Guidance and manufacturer's declaration – electromagnetic immunity			
The MT-10.1-2 is intended for use in the electromagnetic environment specified below. The customer or the user of the MT-10.1-2 should assure that it is used in such an environment.			
Immunity test	IEC 60601 Test level	Compliance level	Electromagnetic environment - guidance
Electrostatic Discharge(ESD) IEC 61000-4-2	±6 kV contact ±8 kV air	±6 kV contact ±8 kV air	Floors should be wood, concrete or ceramic tile. If floors are covered with synthetic material, the relative humidity should be at least 30%.
Electrical fast transient/burst IEC 61000-4-4	±2 kV for power supply lines ±1 kV for input/output lines	±2 kV for power supply lines ±1 kV for input/output lines	Mains power quality should be that of a typical commercial or hospital environment
Surge IEC 61000-4-5	±1 kV lines to lines ±2 kV lines to earth	±1 kV lines to lines ±2 kV lines to earth	Mains power quality should be that of a typical commercial or hospital environment.

Voltage dips, short interruptions and voltage variations on power supply input lines IEC 61000-4-11	<5% UT (>95% dip in UT) For 0,5 cycle 40% UT (60% dip in UT) For 5 cycle 70% UT (30% dip in UT) For 25 cycle <5% UT (>95% dip in UT) For 5 cycle	<5% UT (>95% dip in UT) For 0,5 cycle 40% UT (60% dip in UT) For 5 cycle 70% UT (30% dip in UT) For 25 cycle <5% UT (>95% dip in UT)	Mains power quality should be that of a typical commercial or hospital environment. If the user of MT-10.1-2 requires continued operation during power mains interruptions, it is recommended that the MT-10.1-2 be powered from an uninterruptible power supply or a battery.
		For 5 cycle	
Power frequency (50/60Hz) magnetic field IEC 61000-4-8	3A/m	3A/m	Power frequency magnetic fields should be at levels characteristic of a typical location in a typical commercial or hospital environment
Note: UT is the a.c. mains voltage prior to application of the test level.			

## Guidance and manufacturer's declaration – electromagnetic immunity for ME EQUIPMENT and ME SYSTEM that are not LIFE-SUPPORTING.

Table 3: Guidance and manufacturer's declaration – electromagnetic immunity			
The MT-10.1-2 is intended for use in the electromagnetic environment specified below. The customer or the user of the MT-10.1-2 should assure that it is used in such an environment.			
Immunity test	IEC 60601 test level	Compliance level	Electromagnetic environment-guidance
Conducted RF IEC 61000-4-6	3 Vrms 150 kHz to 80MHz	V1=3V	Portable and mobile RF communications equipment should be used no closer to any part of the SYSTEM, including cables, than the recommended separation distance calculated from the equation applicable to the frequency of the transmitter.  Recommended separation distance  80MHz to 800MHz 800MHz to 2.5GHz
Radiated RF IEC 61000-4-3	3 Vrms 80MHz to 2.5GHz	E1=3V/m	Where P is the maximum output power rating of the transmitter in watts(W) according to the transmitter manufacturer and d is the recommended separation distance in meters(m).

			<p>Field strengths from fixed RF transmitters, as determined by an electromagnetic site survey, should be less than the compliance level in each frequency range.</p> <p>Interference may occur in the vicinity of equipment marked with the following symbol:</p> 
--	--	--	--

Recommended separation distances between portable and mobile RF communications equipment and the ME EQUIPMENT and ME SYSTEM – for ME EQUIPMENT and ME SYSTEM that are not LIFE-SUPPORTING

Recommended separation distances between portable and mobile RF communications equipment and the MT-10.1-2			
The MT-10.1-2 is intended for use in an electromagnetic environment in which radiated RF disturbances are controlled. The customer or the user of the MT-10.1-2 can help prevent electromagnetic interference by maintaining a minimum distance between portable and mobile RF communications equipment (transmitters) and the MT-10.1-2 as recommended below, according to the maximum output power of the communications equipment.			
Rated maximum output power of transmitter W	Separation distance according to frequency of transmitter m		
	150kHz to 80 MHz $d = \left[ \frac{3.5}{V_1} \right] \sqrt{P}$	80MHz to 800MHz $d = \left[ \frac{3.5}{E_1} \right] \sqrt{P}$	800MHz to 2.5GHz $d = \left[ \frac{7}{E_1} \right] \sqrt{P}$
0.01	0.12	0.12	0.23
0.1	0.37	0.37	0.73
1	1.2	1.2	2.3
10	3.7	3.7	7.3
100	12	12	23

# Warranty Card

Thank you for purchasing our product. Please keep your receipt as proof of purchase for any warranty claim.

Name	Motif Medical	Telephone	844-272-8390
Product Name	Twist	Model	MT-10.1-2
Purchase Date			
Address	8 The Green, #5601 Dover, DE 19901		

## NOTICE

1. This product comes with a 12 month manufacture's warranty on the pump and 90 day warranty for the parts.
2. Warranty does not cover defects caused by misuse, abuse, improper storage or alteration of the product, or use of improper components of failure to comply with the operating instruction to the accessories supplied with the product or normal wear and tear.
3. The user of this product assumes all responsibility and risk for the use of this product.
4. Disposal Guideline: Properly dispose of the device in accordance with local, state and federal regulations.
5. Warning: No modification of this equipment is allowed.



## Motif Twist Double Electric Breast Pump



Name: Motif Twist  
Model: MT-10.1-2  
Input: 500mA  
Voltage: 6V  
Address: 8 The Green, Suite 5601  
Dover, Delaware 19901  
Telephone: (844)272-8390  
E-mail: [info@motifmedical.com](mailto:info@motifmedical.com)  
URL: [www.motifmedical.com](http://www.motifmedical.com)

---